

S.NO	CATALOG NUMBER	ENCLOSURE OPTIONS
1	LPTE14-750	ALUMINUM BUS BARS AND CABINETS
2	LPTE14-750C	PLASTISOL COVERS FOR BUS BARS
3	LPTE14-750T	TIN PLATED BUS BARS
4	LPTE14-750SS	STAINLESS STEEL CABINETS

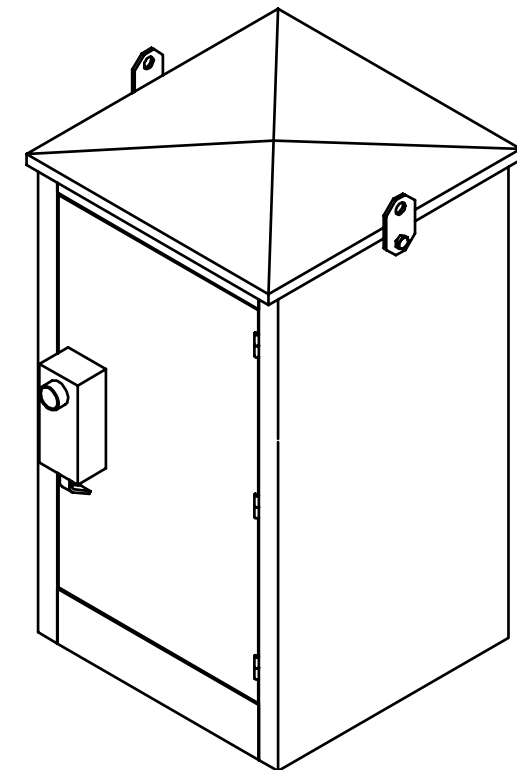
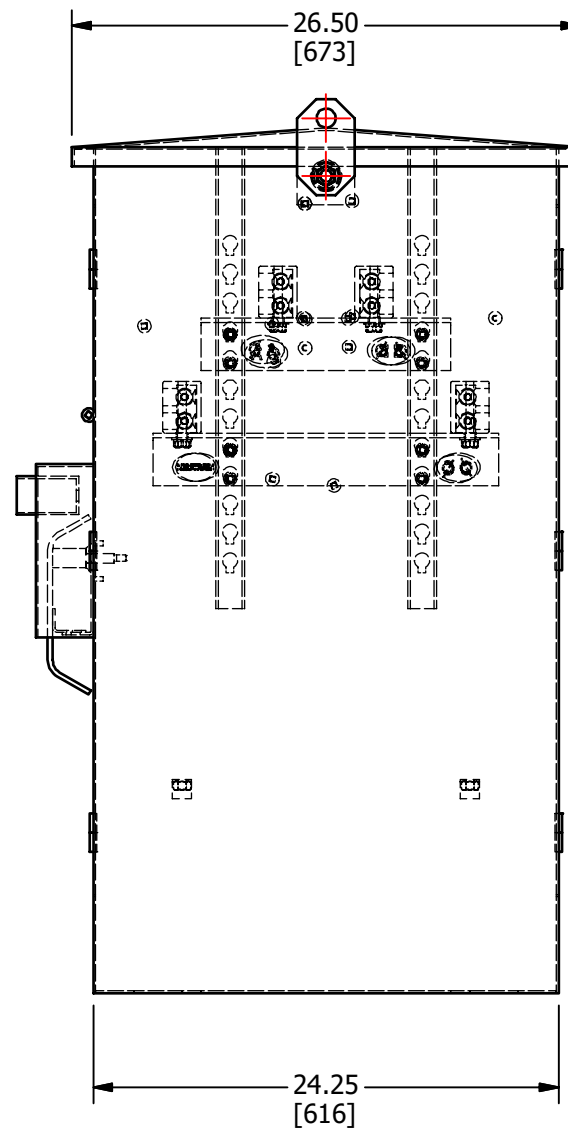
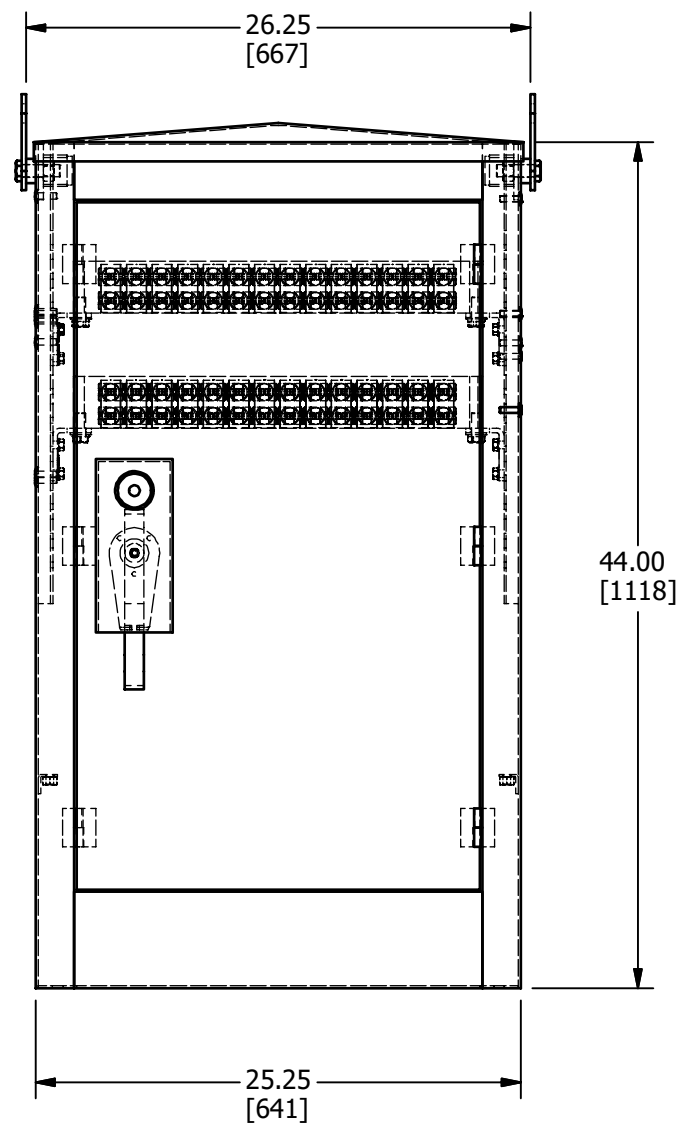

MATERIAL
ENCLOSURE: ALUMINUM
CONNECTORS: ALUMINUM

AMPERAGE RATING
3325 (COPPER WIRE)
2695 (ALUMINUM WIRE)

CONDUCTOR RANGE
750KCMIL-2

NUMBER OF CONDUCTORS: 14
CERTIFICATION: UL

REV.	DESCRIPTION	ECN	DATE	INIT.
A	NEW DRAWING CREATED		11-07-18	TS

TO ORDER CMC PRODUCTS CALL 1-513-860-4455 FOR PRODUCT INFO: http://www.cmcclugs.com	DRAWN BY: TS 11-07-18	NAME OF PART: ENCLOSURE ASSEMBLY	CAT. NO.: SEE TABLE
	CHECKED BY:	DWG NO: U22700004-S (CHARTED)	B
DRAWING NOT TO SCALE		SHEET NO: 1 OF 1	

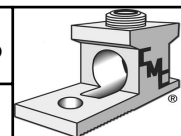

THIS INFORMATION IS PROPRIETARY TO CONNECTOR MFG. CO. AND IS NOT TO BE DISCLOSED OUTSIDE OF CONNECTOR MFG. CO. WITHOUT A CONFIDENTIALITY AGREEMENT



CONNECTOR MANUFACTURING CO.

HAMILTON, OHIO